

LEGENDVIZ™ BLINKERSIGN®

Shown to increase sign legibility distance by as much as 100 percent compared to standard traffic signs*, LegendViz™ BlinkerSigns feature highly visible, LED-illuminated legends for improved visibility at night.

- Enhanced sign legibility without retroreflectivity or headlights
- Designed for quick and easy one-person installation
- Perimeter LEDs automatically dim based on ambient light, maintaining optimal LED output
- Legend illuminated from dusk to dawn
- 7+ days of solar autonomy
- Solar or AC power options for flexible configuration
- MUTCD compliant
- Made in the USA



*According to the results of a closed-course driver trial and statistical analysis conducted by the Texas A&M Transportation Institute (TTI)

LEGENDVIZ™ APPLICATIONS



LOW AMBIENT LIGHT CONDITIONS



PERPENDICULAR OR OFFSET ANGLES



PROBLEMATIC LOCATIONS

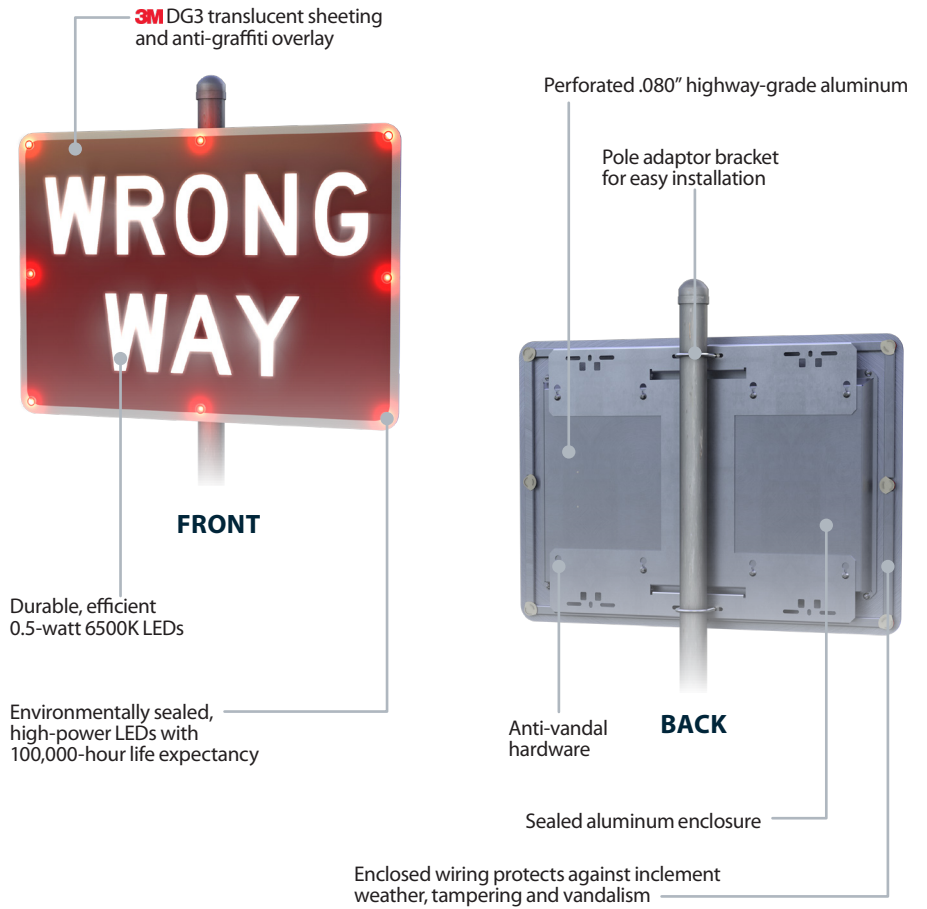

SPECIFICATIONS

POWER	6VDC - 12VDC or low voltage; current controlled through TAPCO controller
SIGN SUBSTRATE	0.080" highway-grade aluminum; perforated legend
REFLECTIVE SHEETING	3M™ translucent DG3; anti-graffiti overlay
LEGEND ILLUMINATION	Dusk 'til Dawn or vehicle-activated nighttime illumination
PERIMETER ILLUMINATION	24/7, Dusk 'til Dawn or activated
LED COLOR	Perimeter: Red Legend: White
LED LIFE EXPECTANCY	Perimeter: 100,000 hours Legend: 50,000 hours
PERIMETER LED VISIBILITY	More than 1,000 feet daytime; more than 1 mile nighttime
LEGEND LED VISIBILITY	Nighttime viewable up to 500 feet Nighttime readable up to 300 feet
OFFSET LEGEND LEGIBILITY	Illuminated sign legible without retroreflectivity or headlights; legible at twice the distance of standard signs*
WIRING PROTECTION	Perimeter LEDs protected by enclosed aluminum channels Legend LEDs protected by sealed aluminum enclosure
MOUNTING BRACKETS	Universal mounting brackets included
SIGN DIMENSIONS	Stop (R1-1): 30" x 30" Wrong Way (R5-1a): 42" x 30" Do Not Enter (R5-1): 30" x 30"

*According to the results of a closed-course driver trial and statistical analysis conducted by the Texas A&M Transportation Institute (TTI)

(800) 236-0112

TAPCO.net.com